



2100 South Clearwater Drive
Des Plaines, IL 60018
Phone: 847-803-5000
Fax: 847-803-5454
www.chicagofaucets.com

FOR TECHNICAL ASSISTANCE
1-800-TEC-TRUE (1-800-832-8783)

ROUGH-IN

BY: SID DATE: 08-22-13
CHK: *AK* REV: 07-06-16

FITTING NO.

HCJKABCP

SUBMITTED MODEL NO.

SUBMITTED AS SHOWN

SUBMITTED AS NOTED

SEE ATTACHED FOR
SUBMITTED MODIFICATION

JOB NAME

ITEM NO.

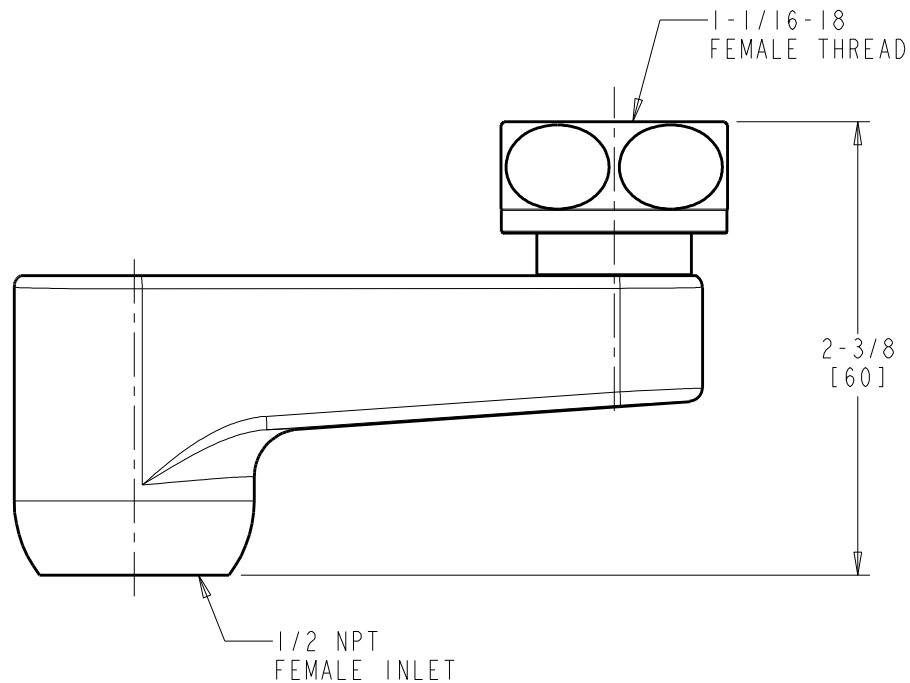
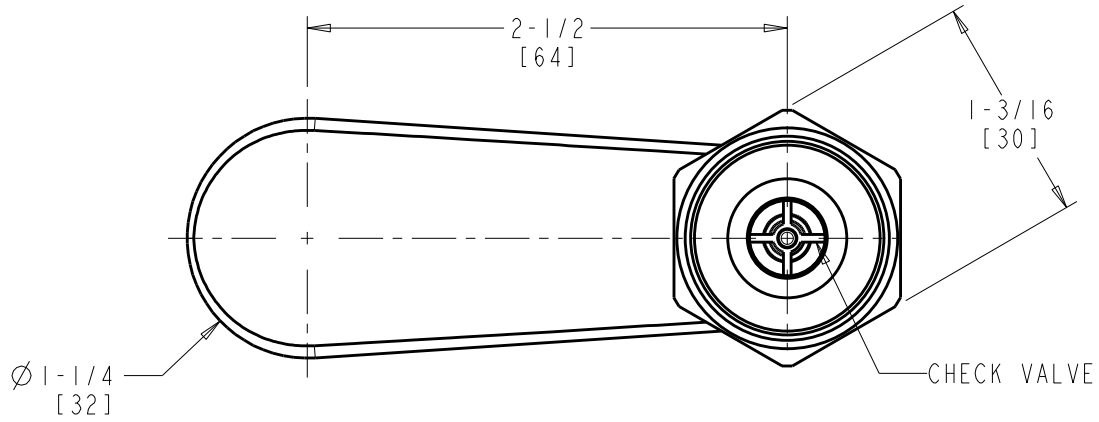

DIMENSIONS ARE IN INCHES AND [MILLIMETERS].

TECHNICAL DATA

- 2 1/2" OFFSET INLET SUPPLY ARM WITH INTEGRAL CHECK
- 2-5/16 DIAMETER SLIP FLANGE REQUIRED (ORDER SEPARATELY)
- FINISH: CHROME PLATE

ROUGHING IN DIMENSIONS MAY VARY AND ARE SUBJECT TO CHANGE. NO RESPONSIBILITY IS ASSUMED FOR USE OF SUPERCEDED OR VOIDED DATA.