



a Geberit company

2100 South Clearwater Drive  
Des Plaines, IL 60018  
Phone: 847-803-5000  
Fax: 847-803-5454  
www.chicagofaucets.com

**FOR TECHNICAL ASSISTANCE**  
1-800-TEC-TRUE (1-800-832-8783)

# ROUGH-IN

BY: JAR DATE: 03-01-13

CHK: *JAR* REV:

FITTING NO.

E1JKABRCF

SUBMITTED MODEL NO.

SUBMITTED AS SHOWN

SUBMITTED AS NOTED

SEE ATTACHED FOR  
SUBMITTED MODIFICATION

JOB NAME

ITEM NO.

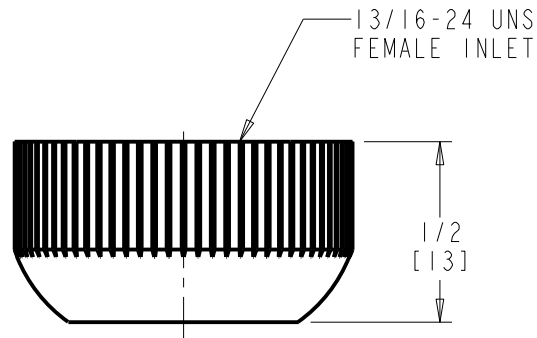
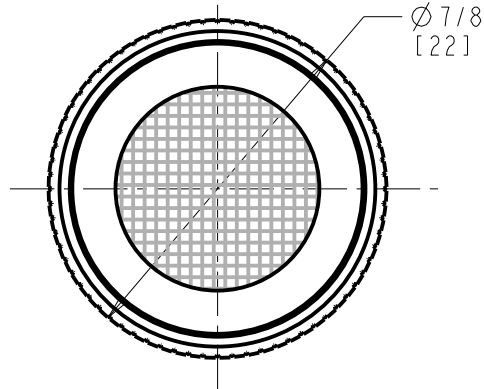

DIMENSIONS ARE IN INCHES AND [MILLIMETERS].

### TECHNICAL DATA

- QUIXTOP WITH SINGLE SCREEN OUTLET  
- FINISH: ROUGH CHROME

- MEETS THE LEAD CONTENT REQUIREMENTS OF:  
CALIFORNIA, VERMONT AND NSF/ANSI 372

ROUGHING IN DIMENSIONS MAY VARY AND ARE SUBJECT TO CHANGE. NO RESPONSIBILITY IS ASSUMED FOR USE OF SUPERCEDED OR VOIDED DATA.