

ROUGHING IN DIMENSIONS MAY VARY AND ARE SUBJECT TO CHANGE. NO RESPONSIBILITY IS ASSUMED FOR USE OF SUPERCEDED OR VOIDED DATA. (0192-1)

CHICAGO. FAUCETS

2100 SOUTH CLEARWATER DRIVE
DES PLAINES, ILLINOIS 60018-5999

FITTING NO.

WXF

SUBMITTED MODEL NO.

JOB NAME

ITEM NO.

SUBMITTED AS SHOWN

SUBMITTED AS NOTED

SEE ATTACHED FOR
SUBMITTED MODIFICATION

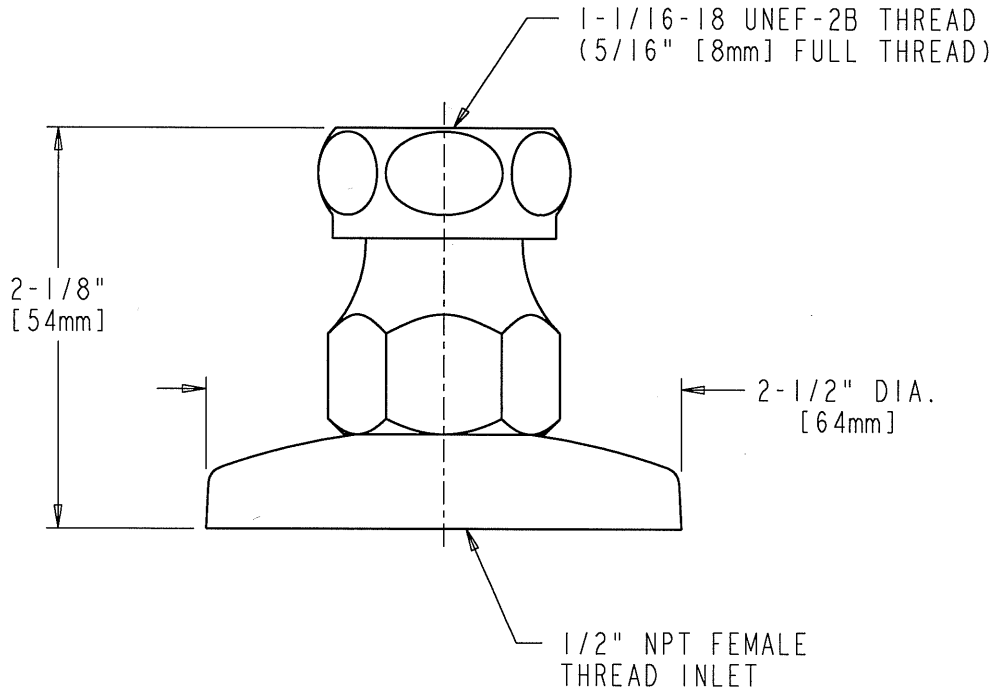

DIMENSIONS IN INCHES AND [MILLIMETERS].

TECHNICAL DATA

- STRIAIGHT INLET SHANK WITH WALL FLANGE
- POLISHED CHROME FINISH

DATE: 03-30-98

BY: MGM

CHK'D: *JWC*

APP'D: *ZK 10/1/98*

REV:

WXF