



a Geberit company

2100 South Clearwater Drive
Des Plaines, IL 60018
Phone: 847-803-5000
Fax: 847-803-5454
www.chicagofaucets.com

REPAIR PARTS

BY: SID DATE: 04-09-02

CHK: *[Signature]* REV: 10-22-14

FITTING NO.

969-217XLHCTF

SUBMITTED MODEL NO.

ITEM NO.

FOR TECHNICAL ASSISTANCE
1-800-TEC-TRUE (1-800-832-8783)

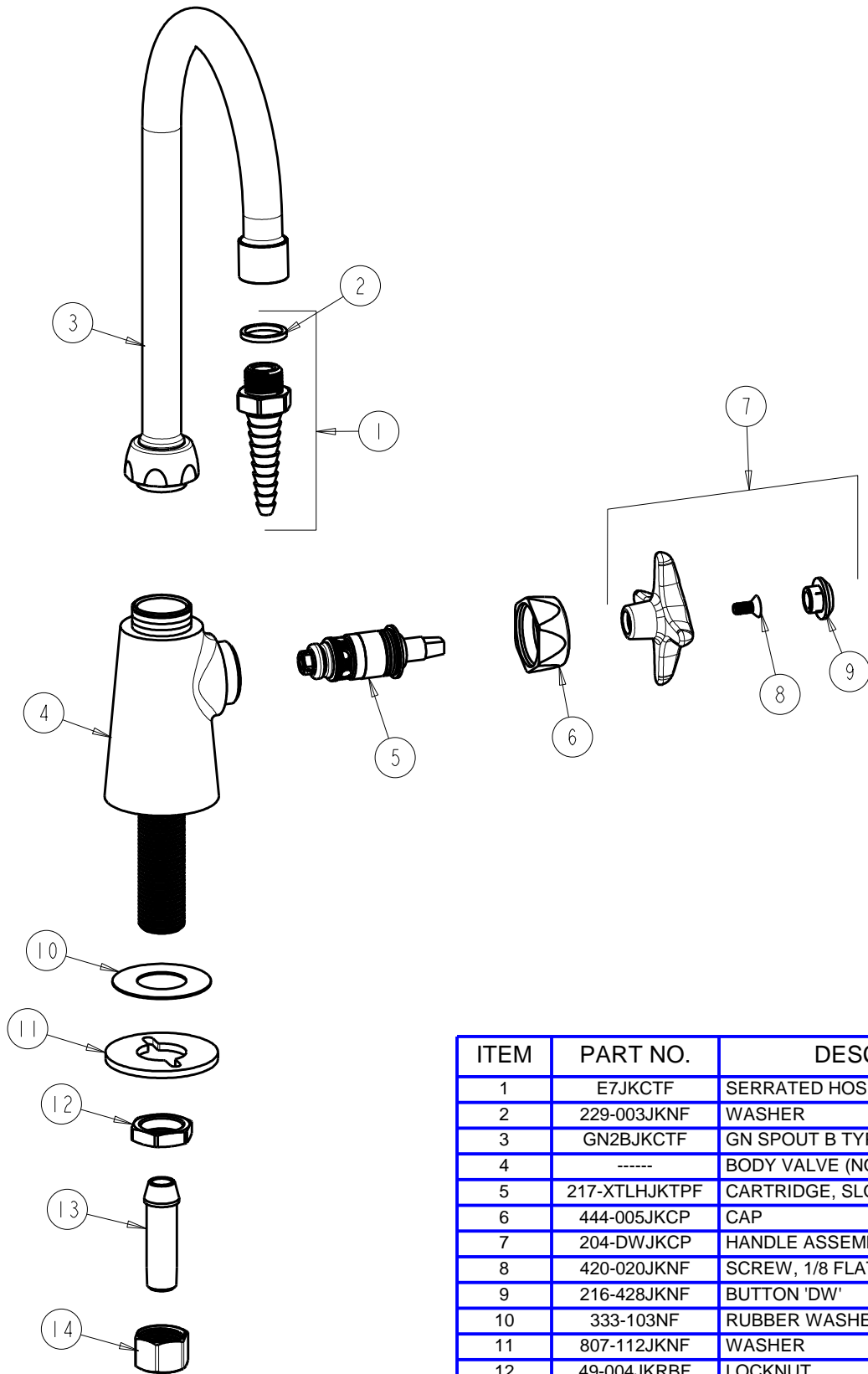

ITEM	PART NO.	DESCRIPTION
1	E7JKCTF	SERRATED HOSE NOZZLE
2	229-003JKNF	WASHER
3	GN2BJKCTF	GN SPOUT B TYPE END
4	-----	BODY VALVE (NOT SOLD SEPARATELY)
5	217-XTLHJKTPF	CARTRIDGE, SLO-COMPRESSION
6	444-005JKCP	CAP
7	204-DWJKCP	HANDLE ASSEMBLY
8	420-020JKNF	SCREW, 1/8 FLAT HEX HEAD X 1/2
9	216-428JKNF	BUTTON 'DW'
10	333-103NF	RUBBER WASHER
11	807-112JKNF	WASHER
12	49-004JKRBF	LOCKNUT
13	49-006JKTPF	TAILPIECE
14	49-005JKRBF	COUPLING NUT