

## GEBERIT MANUFACTURING, INC. WARRANTY

Geberit offers a limited lifetime warranty on the carrier. The pressure tank (vessel) has a 5 year limited warranty, one year on toilet bowl and flush actuator plate.

Geberit will either replace or repair the defective item, or refund the purchase price, at its option, if an inspection by Geberit or its authorized representative disclose any manufacturing defects in material or workmanship during this time period. Geberit will not be liable for any labor or other expenses not specifically stated above, and disclaims any responsibility for incidental or consequential damages attributed to a product defect or to the repair or exchange of a defective product, all of which are expressly excluded from this warranty. Some states or provinces do not allow the exclusion or limitation of implied warranties, so this exclusion may not apply to you.

This warranty does not apply to local building code compliance. Since local building codes vary considerably, the purchaser of this product must check with a local building or plumbing contractor to ensure local code compliance before installation.

This warranty shall be void if the product has been moved from its initial place of installation; if it has been subject to faulty maintenance, abuse, misuse, accident or other damage; if it was not installed in accordance with Geberit's instructions; or if it has been modified in a manner inconsistent with the product as shipped by Geberit.

For service under this warranty, it is suggested that a claim be made through the contractor or dealer from or through whom the product was purchased, or that a service request (including a description of the product model and of the defect) be sent to the address below.

#1471 12/02 Rev B.

994.947.00.0

# Pressure Assist Toilet System

## Installation Instructions



- Wall Hung Bowl Mod. 111.875
- Tank & Carrier Mod. 111.817

### Geberit Manufacturing, Inc.

1100 Boone Dr., Michigan City, IN 46360  
U.S.: Phone 219.879.4466 • Toll-Free 800.225.7217 • Fax 219.872.8003  
Canada: Inquiries in Quebec: Toll-Free 866.748.4646 • Fax 514.648.8509  
Inquiries in English: Toll-Free 800.225.7217 • Fax 219.872.8003  
[www.us.geberit.com](http://www.us.geberit.com)

**GEBERIT**  
Advanced plumbing technology

**GEBERIT**  
Advanced plumbing technology

**PRESSURE ASSIST TOILET SYSTEM WITH WALL-HUNG BOWL**

**Product Specifications**

Pressure assist in-wall tank & carrier system with wall-hung 4-hole elongated toilet bowl and die-cast actuator plate.

Tank & carrier system shall fit within standard 2 x 6 wall studs placed 16" (406) on center; water supply shall be 1/2" copper, minimum water pressure 35 PSI. The bowl shall comply to ASME A112.19.2 Vitreous China fixture standard to be mounted with 4 bolts 1/2" UNC onto the carrier. The carrier shall have adjustable height for 15" (381) to 19" (483) bowl rim height. The unit shall flush on 1.6 GPF (6 L). Actuator panels shall be die-cast zinc and plated to preserve the material's integrity.

**Warranty**

Five years on pressure vessel;  
Limited Lifetime on steel carrier system;  
One year on toilet bowl;  
One year on flush actuator plate.

**Options**

- Polished chrome actuator plate (115.762.21.1)
- Matte chrome actuator plate (115.762.46.1)
- Discharge Elbows 3" DWV SCH-40
  - Horizontal Left (366.914.16.1)
  - Horizontal Right (366.913.16.1)
  - Back to back (367.485.16.1)
  - Cast-iron 90° (860.832.00.1)
- Seat, closed front with lid (113.050.DY.1)

**Features**

- PF2® Mod. 160 pressure vessel
- Steel, powder-coated carrier
- Die-cast actuator dimension:
  - 9 1/2" (245) wide
  - 6 1/2" (165) high
- 3" DWV discharge elbow 90°
  - with lowflex shielded coupling
- Bowl pass way 2 1/4"
- Carrier height adjustable range 15" (381) to 19" (483) bowl rim height
- Water consumption – 1.6 GPF (6 LPF)
- Large Water spot 10 1/2" (265) x 12" (305)
- Easy sanitation of surrounding areas

**In compliance with**

- ASME A112.6.2-2000
- ASME A112.19.2M-1998
- ASME A112.19.6-1995
- ASSE 1037
- CSA - B125



**System Contains:**

- Model 111.817 Tank & Carrier
- Model 111.875 Wall- Hung Bowl
- Model 111.762 Actuator Plate

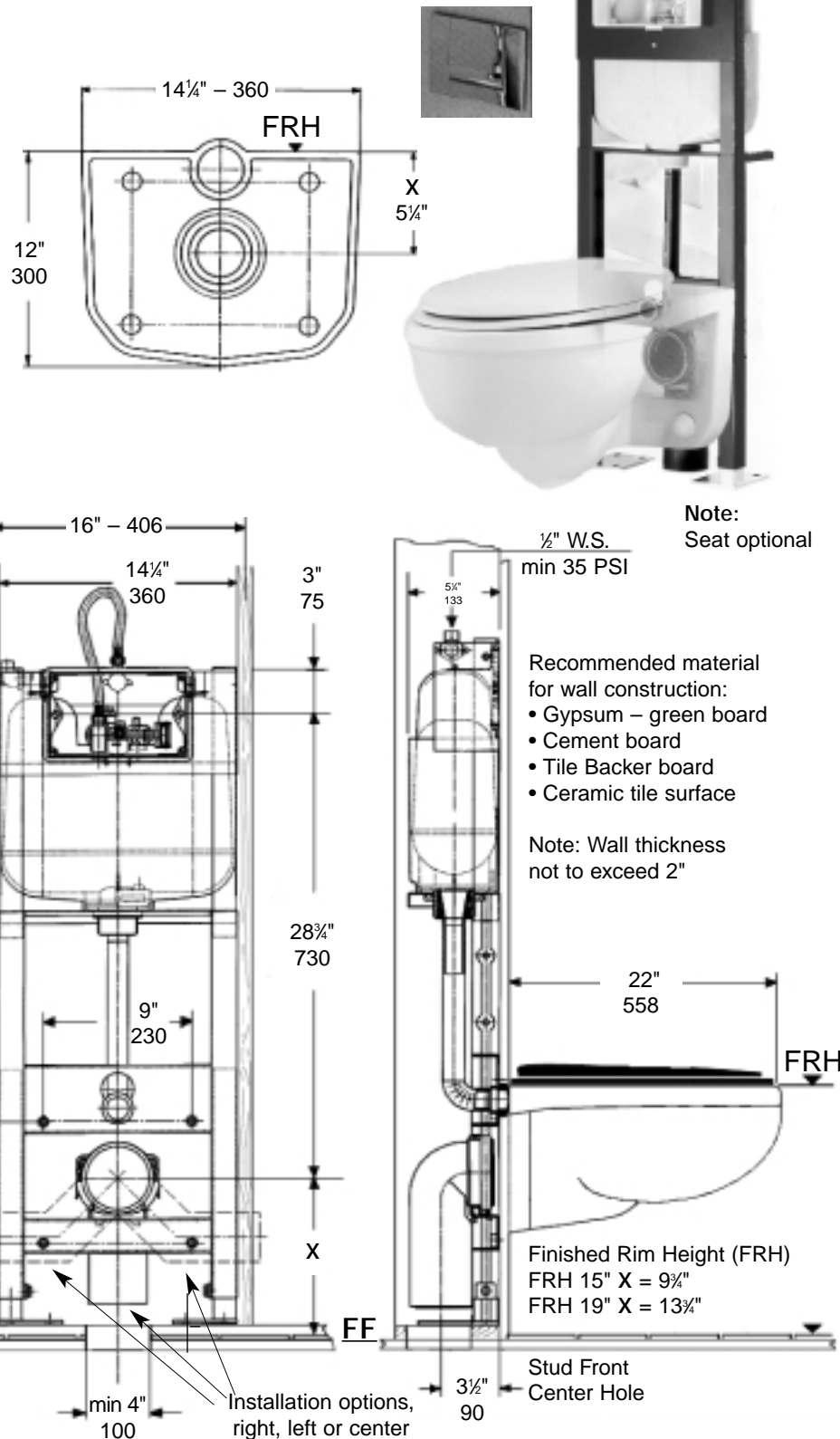

**Access Panel-Flush Actuator Installation**

16

■ For flush actuator installation, adjust actuator rod so it extends only 3/8" (9.5 mm) in front of actuator frame surface, as shown.

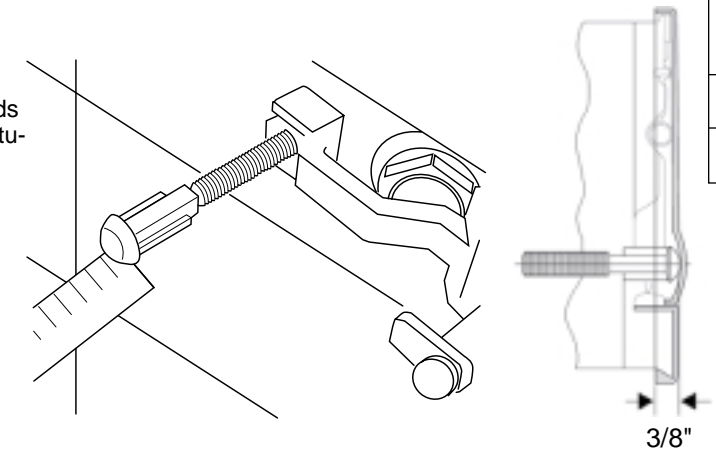

Note Actuator #	Y Length
115.762	3/8"
115.756	5/8"

17

■ Secure frame to lock pins with two 1/2" self-tapping screws provided.

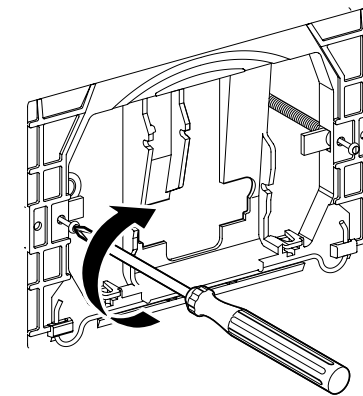

18

■ To complete the installation attach the actuator panel to spring, on lower side, push up and snap over the upper edge in place.

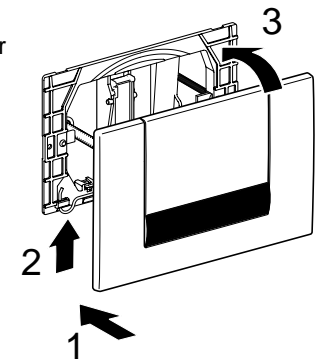

19

■ Test actuator for functionality.

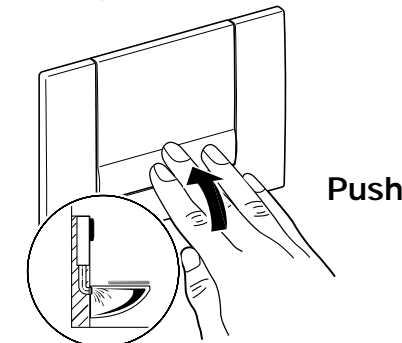

20

■ Install screws for vandal resistance (A).  
■ Remove protective film (B).

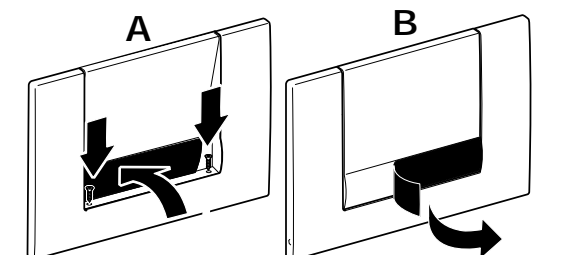

## Access Panel-Flush Actuator Installation

**10**

- Remove box guard cover.
- Trim off excess material flush with wall.
- Discard cover and excess material.

**11**

- Measure wall thickness X.

**12**

- Cut lock pins to length  $X + \frac{1}{2}$ "

**13**

- Install threaded lock pins and adjust length flush with finished wall.

**14**

- Purge supply line, connect hose to stop valve and fill tank with water. Flush system repeatedly.
- Check for leaks.

**15**

- To install actuator push rod, measure for dimension Y from finished wall surface to face of lever bushing, and add 1". Cut actuator push rod to length  $Y + 1$ ".

## Pressure Assist System – Installation Requirements Tank and Carrier – Installation

To install the "Pressure Assist System" a 2x6" wood stud or 2x6" metal stud wall construction will be required. The studs next to the carrier location need to be placed for an opening of 14½" clearance or 16" C-C. Metal studs require wood reinforcement placed inside of the u-channel.

The Finished Rim Height (FRH) for the Bowl must be determined prior to the carrier installation!

For FRH 15" adjust carrier legs that the dimension between center of discharge elbow and raw floor measures 9¾". Allow for height (+) of finished floor covering. For other settings subtract (-) 5¼" from FRH to find X dimension.

**STEP 1:** Locate supporting studs, and secure with additional nails. Ensure rough openings are proper, plumb, and square. The 2 x 6 framework must be affixed firmly to the floor and ceiling for proper installation.

**STEP 2:** Position the carrier unit in the prepared opening. The metal frame must be flush with the face of the surrounding studs so that maximum support for the wall surface (applied later) is accomplished. With the unit still in place, mark all anchor hole locations on sole plate and studs. Mark the location for the 3" discharge elbow on the sole plate if discharge is to be vertical.

**STEP 3:** Pull out carrier unit from framework and drill six (6) pilot holes (3/16") for the supplied lag screws where marked on sole plate. Also drill four (4) bolt holes (5/16") where marked on studs. For the fixture discharge pipe bore a 4" hole on sole plate where previously marked. Set carrier unit back into the framework and bolt in place with hardware provided.

**STEP 4:** Use 3" shielded coupling (provided) to complete waste line connection.

**STEP 5:** Install ½" water supply line nominal into ½" NPT drop ear elbow. If soldering copper, allow for sufficient cooling time prior to shut off valve installation. Before turning water on, ensure shut-off valve is closed. **Note:** After turning source water on, disconnect braided supply hose from fill valve and purge water supply line into container.

**STEP 6:** Install four (4) ½" x 6" fixture rods (A) with plastic sleeves. Estimate total wall thickness and add 3" for approximate fixture rod installation. Attach guard box (B) to front of carrier, follow diagrams 1 thru 3. See Figure 1.

**STEP 7:** Install wall surface material such as high density 5/8" Gypsum, Tile Backer Board or Cement Board as the most suitable materials. Provide cut outs for rods, inlet and outlet pipes and access opening.

**Note:** For finish installation of bowl and actuator panel see detailed instruction.

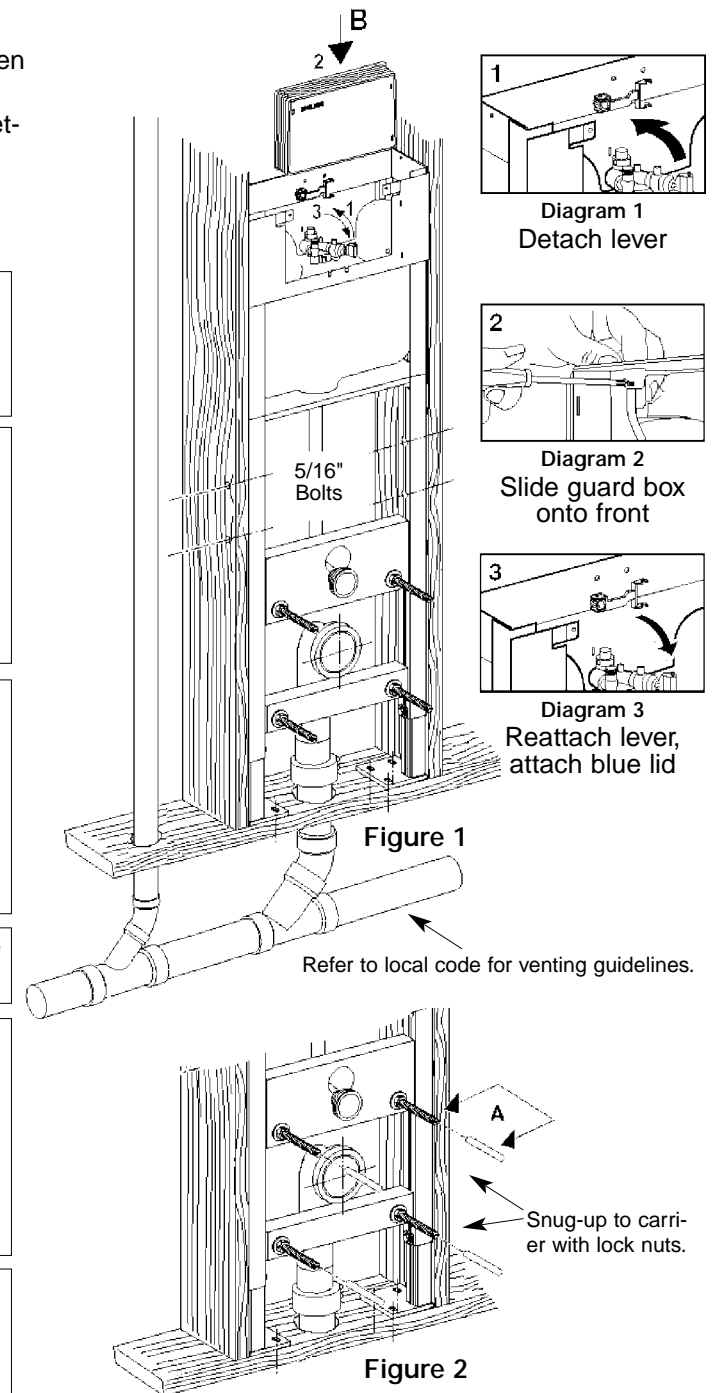

## Bowl Installation

**1**

- Remove plugs from fill and discharge openings.
- Insert discharge pipe into pipe hub in wall.
- Place straight edge flush against wall and mark a line for dimension A onto pipe.
- Assemble inlet gasket onto fill pipe. Repeat same procedure.

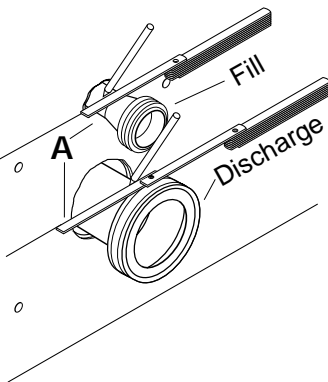

**2**

- Place discharge pipe with gasket onto waste outlet of bowl.
- Place fill pipe with gasket into inlet of bowl.
- Mark a second line for dimension B on both pipes.

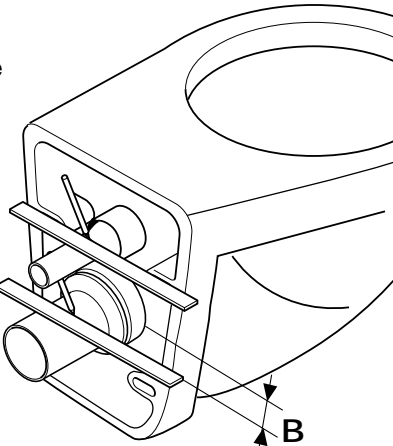

**3**

- Add dimension A and B and subtract 1/8".
- Using that dimension, mark a line onto discharge pipe measuring from the hub side.
- Cut off the excess pipe at the line with hacksaw.
- Repeat for fill pipe.

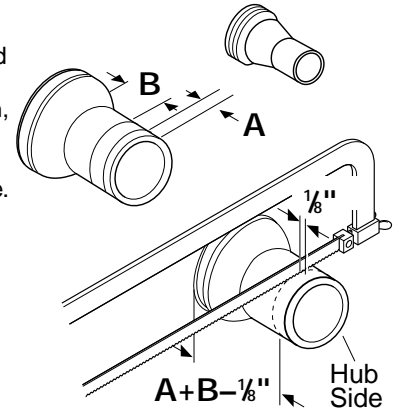

**4**

- Bevel the rough and sharp edge as shown to assure a smooth insertion into the pipe hubs in the wall.

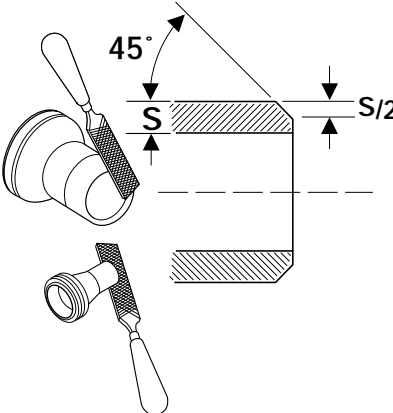

**5**

- Lubricate seals with appropriate rubber seal lubricant.
- Install both pipes into the hubs in wall.
- Remove protective sleeves from mounting rods.

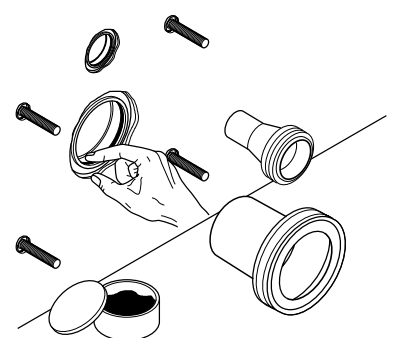

**6**

- Install tile cushion pad over (4) mounting rods. Note: The tile cushion pad is optional, separate order required.

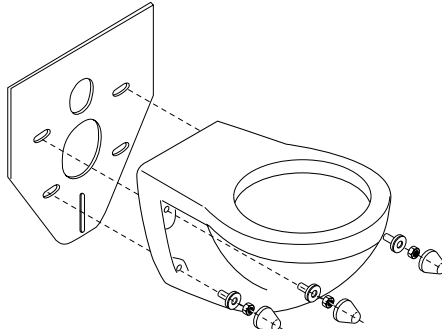

## Bowl Installation

**7**

- If necessary, adjust mounting rods to project 3" from face of finished wall.
- Secure with locknut against the carrier.

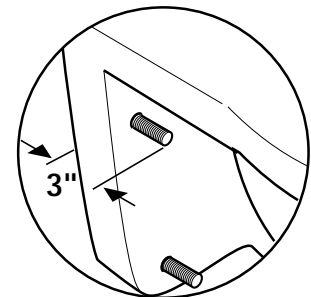

**8**

- Place bowl onto rods.
- Attach cap retainers (1), washer (2), and nuts (3) on both sides loosely.
- Level bowl.
- Tighten nuts. DO NOT OVERTIGHTEN.
- Snap caps (4) over retainers.

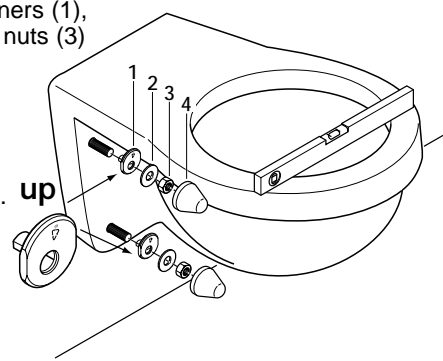

**9**

- Caulk around bowl with waterproof sealant.

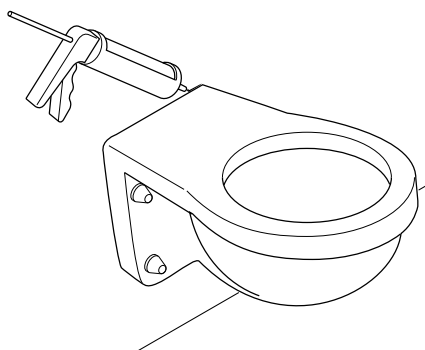
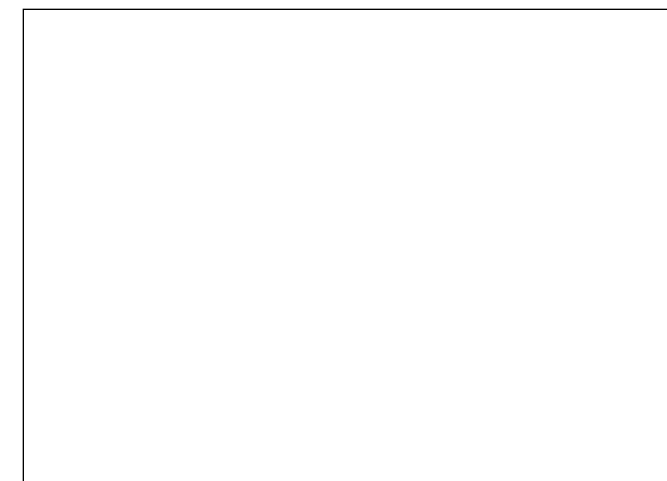
- Please turn page for Access Panel and Flush Actuator Installation instructions.

